



AGES 4+
64440/64420 Asst.

Welcome to

Ponyville®

Sweet Sundae Amusement Park™

Thank you for purchasing this
My Little Pony® product!

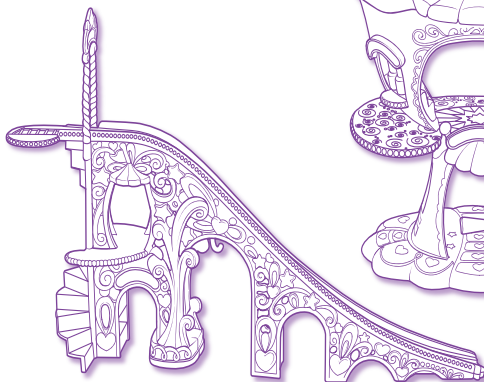

WARNING:

CHOKING HAZARD - Small parts.
Not for children under 3 years.

 x3

BATTERIES INCLUDED

Replace with 3 x 1.5V "AA" or LR6 size alkaline batteries.
Phillips/cross head screwdriver (not included) needed to
replace batteries.

GETTING STARTED

This product is packaged in “DEMO” mode. Activate its full range of features by moving the ON/OFF/DEMO switch to the “ON” position. Switch is located in back of the Ferris wheel.

NOTE: This toy uses battery power whenever its switch is in the “ON” position. To help conserve battery life, move the switch to “OFF” position when you’re not playing with the toy.

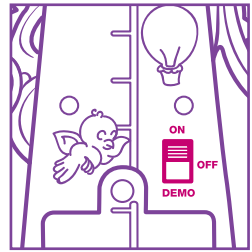

TO PLAY

Roller Coaster

- Place pony in boat and hook under the arch of the roller coaster frame.

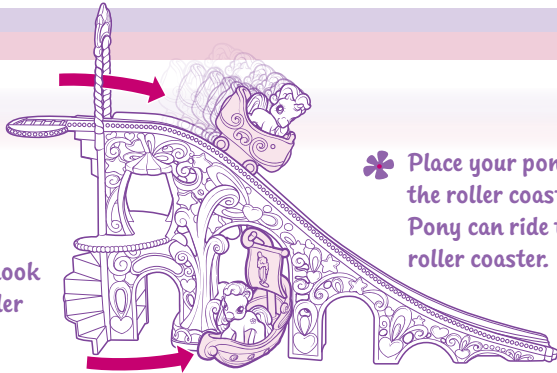

- Place your pony in the roller coaster car. Pony can ride the roller coaster.



Ferris Wheel

- Place pony in the ice cream cups.
- Press the heart button to activate lights, sound and Ferris wheel rotation. Press heart again to stop.

Ice Cream Parlor

- Ice cream parlor top opens to reveal the food court area.

- You can push the bottles back and they'll spring up.
- Pony can go through turnstile.

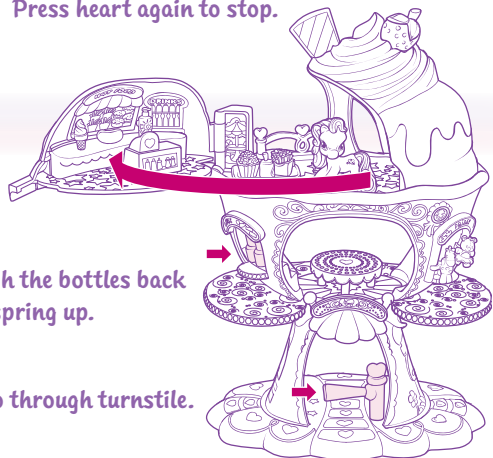

TROUBLESHOOTING

If the lights, sound and Ferris wheel rotation are not functioning properly, reset or replace the batteries.

TO REPLACE BATTERIES

Using a Phillips/cross head screwdriver (not included), loosen screw in battery compartment cover (screw stays attached to cover). Insert 3 x 1.5V “AA” or LR6 size alkaline batteries (not included). Replace cover and tighten screw.

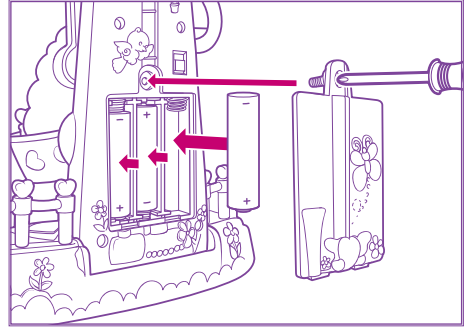

CAUTION:

1. Be sure to insert the batteries correctly and always follow the toy and battery manufacturers' instructions;
2. Do not mix old batteries and new batteries or alkaline, standard (carbon-zinc) or rechargeable (nickel-cadmium) batteries;
3. Always remove weak or dead batteries from the product.

IMPORTANT: BATTERY INFORMATION

Please retain this information for future reference.
Batteries should be replaced by an adult.

CAUTION:

1. Always follow the instructions carefully. Use only batteries specified and be sure to insert item correctly by matching the + and – polarity markings.
2. Do not mix old batteries and new batteries or standard (carbon-zinc) with alkaline batteries.
3. Remove exhausted or dead batteries from the product.
4. Remove batteries if product is not to be played with for a long time.
5. Do not short-circuit the supply terminals.
6. Should this product cause, or be affected by, local electrical interference, move it away from other electrical equipment. Reset (switching off and back on again or removing and re-inserting batteries) if necessary.
7. **RECHARGEABLE BATTERIES:** Do not mix these with any other types of batteries. Always remove from the product before recharging. Recharge batteries under adult supervision. **DO NOT RECHARGE OTHER TYPES OF BATTERIES.**

FCC Statement

This device complies with part 15 of the FCC Rules. Operation is subject to the following two conditions: (1) This device may not cause harmful interference, and (2) this device must accept any interference received, including interference that may cause undesired operation.

This equipment has been tested and found to comply with the limits for a Class B digital device, pursuant to Part 15 of the FCC Rules. These limits are designed to provide reasonable protection against harmful interference in a residential installation. This equipment generates, uses and can radiate radio frequency energy, and, if not installed and used in accordance with the instructions, may cause harmful interference to radio communications. However, there is no guarantee that interference will not occur in a particular installation. If this equipment does cause harmful interference to radio or television reception, which can be determined by turning the equipment off and on, the user is encouraged to try to correct the interference by one or more of the following measures:

- Reorient or relocate the receiving antenna.
- Increase the separation between the equipment and the receiver.
- Consult the dealer or an experienced radio/TV technician for help.

CAUTION: Changes or modifications not expressly approved by the party responsible for compliance could void the user's authority to operate the equipment.

